



Property Report for Parcel#: 886835

Friday, May 14, 2021

Parcel Information

Address: 140 WINTER PARK LN EASTON
Tax Parcel ID: [886835](#)
Map Number: 21-13-17051-0056
Recorded Area: 0.28 a
Owner Name: DIAMOND, SUSAN L
Name Cont:
Mailing Address: 225 108TH AVE NE STE 400
City/State/Zip: BELLEVUE WA 98004-5782

Critical Areas Information

Contains > 30% Slope: Yes
PHS Site Name: N/A
Roof Hazard: HIGH_EXTREEME HAZARD RATING
Roof Class: CLASS A
Seismic Category: D1
Shore Line: N/A
Wetland Code: N/A
DNR Water Type: N/A
FIRM Zone: ZONE C
FEMA Flood Map: 5300950125B
Coalmine Shaft: N/A
Airport Zone: N/A
BPA Right of Way: -1
Max Elevation: 2359
ISO: 0.076
PG: 179, Engineering is required

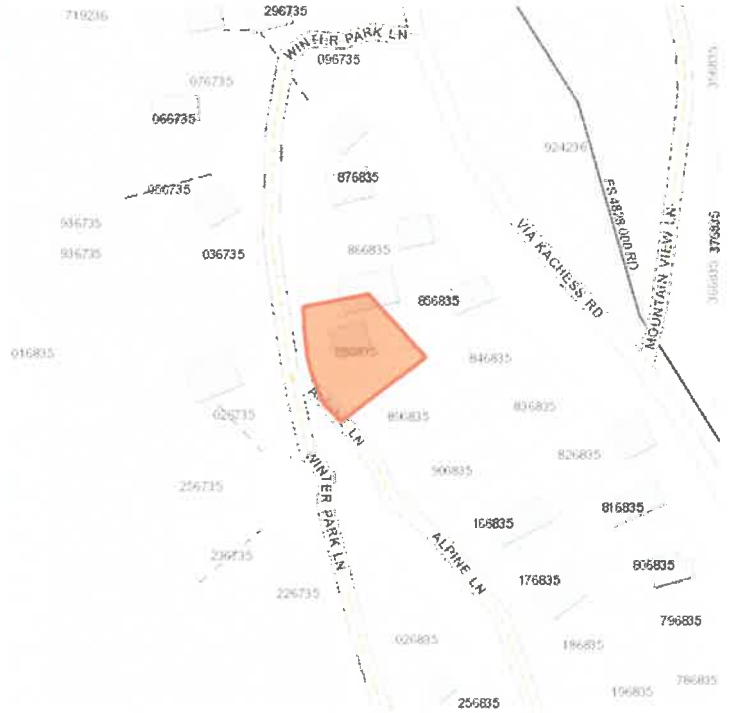

Administrative Information

Zone and Allowed Uses: [Forest and Range](#)
Land Use Category: Rural Working
Commissioner District:
Voter Precinct: Kachess
Hospital District: HOSPITAL DISTRICT 2
School District: Easton School District
Irrigation District: N/A
Weed District:
Fire District: Snoqualmie Pass Fire and Rescue
Cemetery District: N/A
Court District: Upper District Court
PUD Comm District: District 2
Parks and Rec District: District 1
Wildland Urban Interface: [IR 1](#)
Stock Restricted Area: Open Range
COE Gas Service Area: No

Domestic Water Information

Groundwater Permit Required? Yes, [Suitability Map](#)
Qualifying Water Banks: Big Creek WR, Bourne, Burchak, KittitasCnty(Clennon), Reecer Creek, KittitasCnty(Roth), New Suncadia(Big Creek), New Suncadia (SwaukFirstCreeks), New Suncadia (TeawayRiver), Roan New Suncadia, Swiftwater Ranch, Trailside, Western Water Partners, Yakima Mitigation Services